

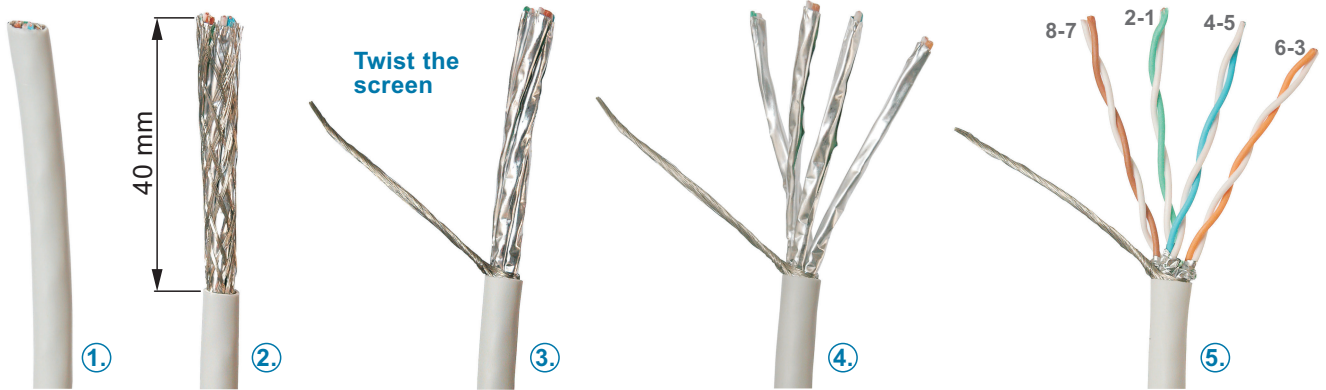

ASSEMBLY INSTRUCTION

NE8FDY-C6 | etherCON Receptacle

A Cable preparation



B Shielding

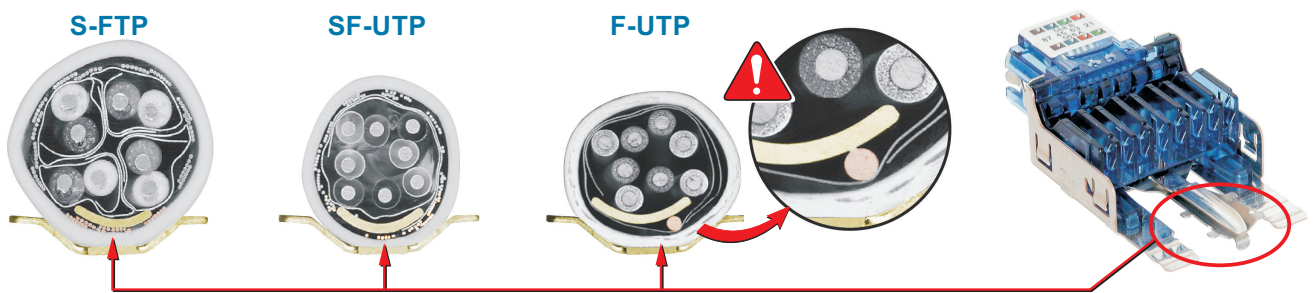

C Cable pairs separation

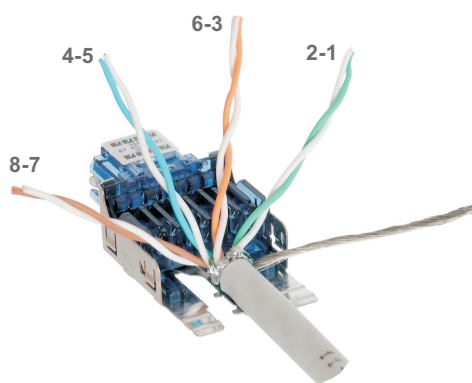

D Cable mount

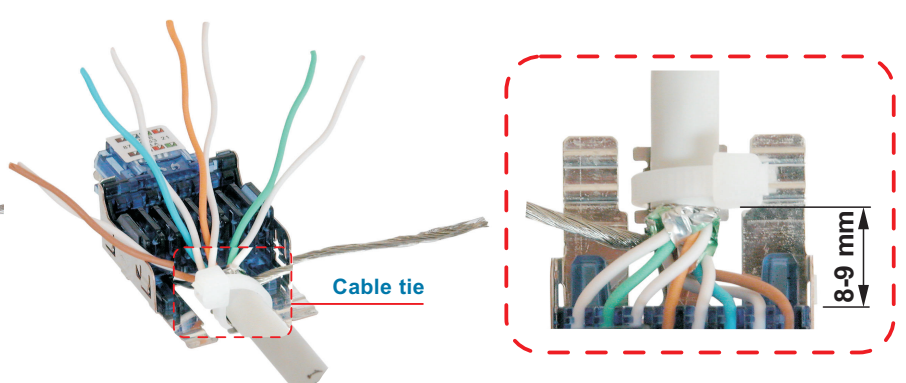

E Position wires acc. label

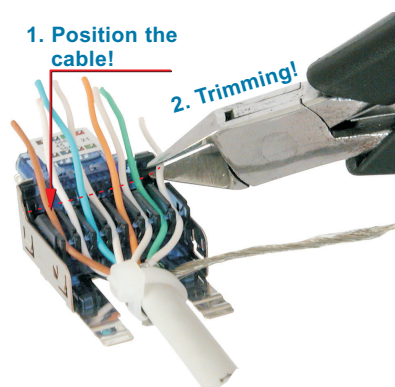

F Fix wires

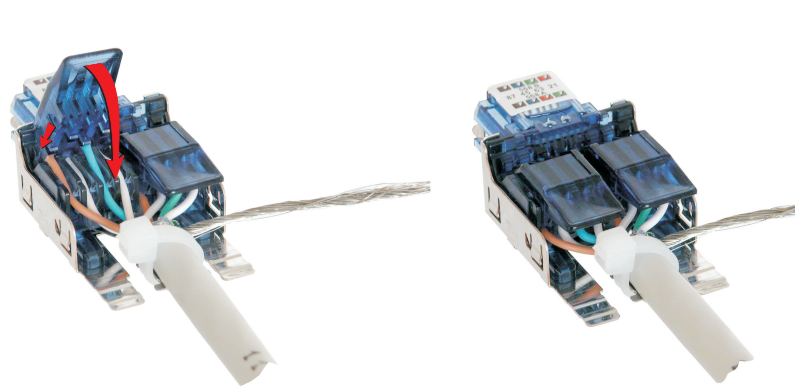



G Cover assembly

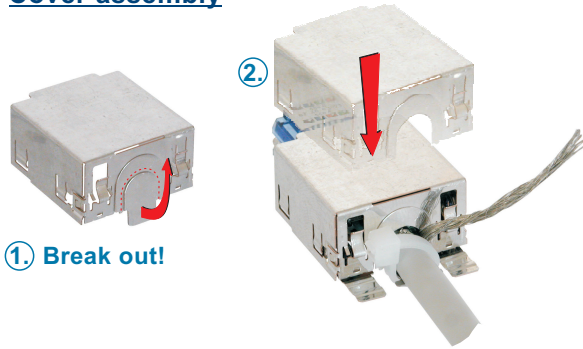

H Connect the screen

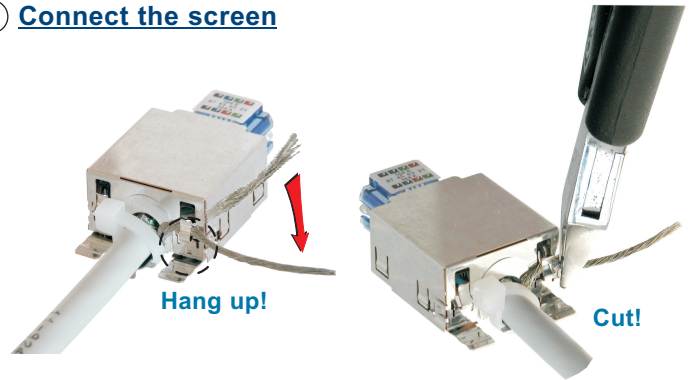

I Assembly the adapter

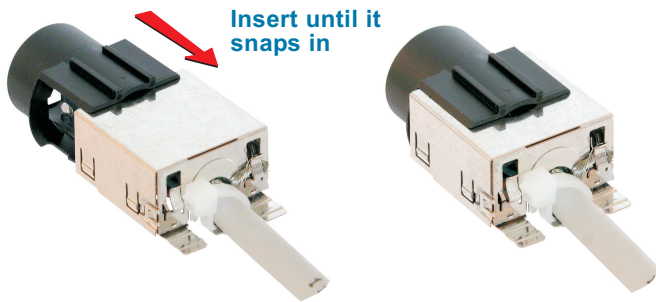

J Grounding option

Insert contact only if screen should be connected to front panel

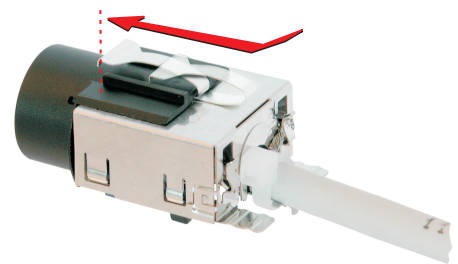

K Assembly the chassis

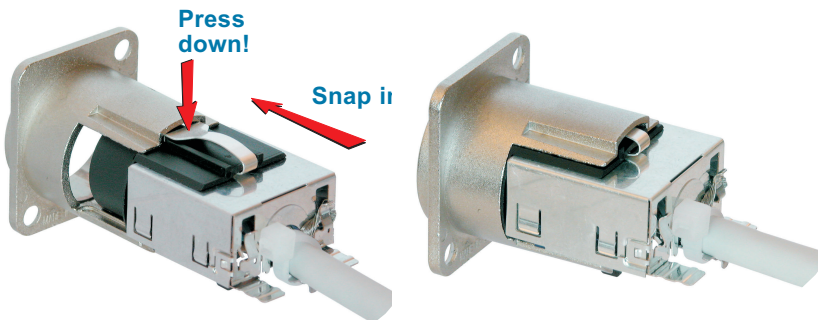

L Finish



Attention: Before assembly secure the housing in the device.

Please fix the cable additionally.

Note for Right-Angle Version

Working steps same as above.

Except:

Step B - References to step B and bend the reinforcement metal right angle below.

Step G - The cable outlet must not be interrupted.

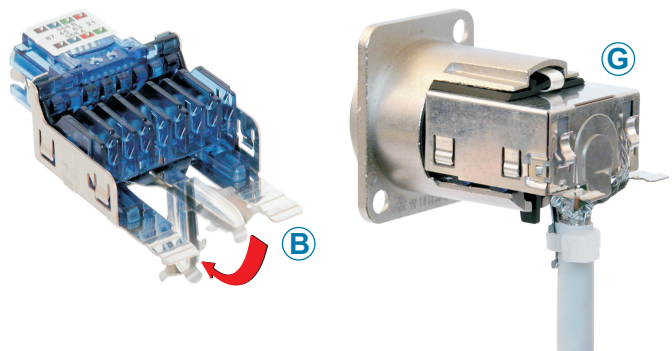

NEUTRIK AG LI T: +423 / 237 24 24 F: +423 / 232 53 93
 NEUTRIK Zürich AG CH T: +41 44 / 736 5010 F: +41 44 / 736 5011
 NEUTRIK USA Inc. USA T: +1 732 / 901 9488 F: +1 732 / 901 9608
 NEUTRIK (UK) Ltd. UK T: +44 1983 / 811 441 F: +44 1983 / 811 439

NEUTRIK Vertriebs GmbH DE/NL/AT/DK T: +49 8131 / 280 890 F: +49 8131 / 280 830
 NEUTRIK France FR T: +33 1 / 4131 6750 F: +33 1 / 4131 0511
 NEUTRIK Tokyo Ltd. JP T: +81 3 / 3663 4733 F: +81 3 / 3663 4796
 NEUTRIK Hong Kong Ltd. HK T: +852 / 2687 6055 F: +852 / 2687 6052